

Over Counter Electric Dispenser

Stream™ 3V

Specification Guide



FEATURES

Excellent Performance

Has a large ice-bank for its compact profile. Ensures continuous draw capacity with beverage quality under various conditions.

Brand Exposure

Large LED lightbox with interchangeable panels, enhancing brand image.

Easy Maintenance

Optimized structure design allows for quick maintenance of key components; removable filter for easy maintenance and cleaning.

Optimized system design

Optimized airflow control, excellent thermal insulation, and efficient heat exchange improve energy efficiency and extend component lifespan.



Safe and Reliable

New water level sensor enhances equipment reliability. Rodent-proof design provides multiple layers of safety protection.

Flexible Configuration

Quick switching between carbonated and non-carbonated options.

Technical Specifications

Model Number	FT-S3C
Item Number	FT13C0020
Electrical Rating	230V 50Hz, 220V 60Hz
Refrigerant	R134a
Ice Bank Size	16.5 lbs. (7.5Kg)
Compressor Size	1/4HP
Operating Conditions	50°F to 90°F (10° C to 32.2°C)
Dimensions	13.8" W x 25.6" D x 26.8"H W350mm x D650mm x H680mm
Recommended Clearance	Top: 18.0" (45cm) Back and side: 6.0" (15.2cm)
Weight	Operating: 200 lbs. (94 kg) Shipping: 132.3 lbs. (60 kg)
Continuous Draw Capacity @ 2 drinks/m @ 12oz/drink	
@90°F (32.2°C) 65%RH	60 drinks
@75°F (24°C) 45%RH	110 drinks
Water Bath Size	36L
Water Connection	3/8" SAE male flare fitting on dispenser
Water Supply Requirements	Optimum Pressure: 30psi (2.04 bar) flowing 3oz/sec Minimum Static Pressure: 20psi (1.36 bar) Maximum Static Pressure: 35psi (2.38 bar)
	For water pressure exceeding the optimum supply specification, flow control set at 50psi is recommended
Flow Rate	Beverage pour rate 1.5-3oz/sec
Agency Listing	 

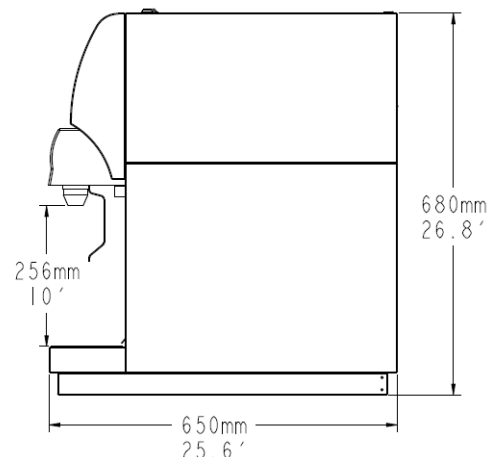
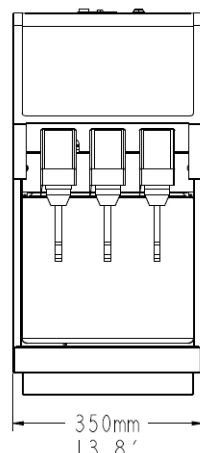

For details about the materials required for installation, please refer to the Installation Manual.